



**Fill-Tech**  
SOLUTIONS, INC.

F

I

L

L

.

I

L

L

L

L

# LETTER FROM OUR CEO

As we begin our second decade in the market providing customers in the food, beverage, pharmaceutical, household consumer products and industrial sectors with specialized packaging engineered solutions, we are proud of our journey and eager to continue building on new opportunities and relationships. At Fill-Tech we realize that people are the most important asset and they are vital to our mission of serving you, our valued customers.

During the past 10 years we have grown not only in size but also in quality, serving clients both locally and abroad. We have expanded our capacity and improved the efficiency of our machines by offering refined mechanical designs and the latest electronic technology. In addition, we have diversified our portfolio of services which now includes: new product designs, conversions, upgrades, rebuilds, refurbishments and consulting services. Our customers now serve consumers of ready-made meals, soups, dairy products, ramen noodles, rice bowls, deli salads, mac & cheese, mashed potatoes, gravies, spices, sauces, dips, frozen yogurt, mozzarella balls, cookie dough, margarine, single dose pharmaceuticals, powder and drink supplements, cleaning wipes/pads and plumber's putty amongst others.

Despite these changes, one thing hasn't changed: our commitment to high-quality work. We strive to exceed our customer's expectations, creating tailor-made solutions by providing the highest quality products in the industry. At Fill-Tech our knowledge and expertise has allowed us to earn the trust of our customers and we take pride in maintaining that trust. To our long-time customers and partners, we say "thank you", and to our new customers, we look forward to earning your trust and your business well into the future.

A handwritten signature in black ink, appearing to read 'SE', followed by a long horizontal line extending to the right.

Stewart Nelson  
Founder, CEO

A smiling man with a beard, wearing a dark green V-neck sweater over a light blue patterned shirt, giving a thumbs up with his right hand. The background is blurred.

# WHAT SOME OF OUR CUSTOMERS SAY

ALEXANDRA CARONE  
FOUNDER/COO, THE HONEST STAND

---

“The Fill-Tech team has been the most reliable, efficient and speedy contractor/supplier we've ever had the pleasure of working with. Their attention to detail and commitment to customer satisfaction is unparalleled in the industry and I would wholeheartedly recommend them to anyone and everyone!”

MIKE SCADUTO  
VP, PACON

---

"From the very first teleconference, Fill-Tech demonstrated confidence and a vast knowledge experience in dealing with our unique tub shape and materials. The Fill-Tech team offered several solutions and options and allowed Pacon to participate in the process as a partner. As a Contract Co-Packer, performance to our customer is vital for continued and new business. Fill-Tech's performance makes us look good!"

TONY AREIAS  
DIRECTOR OF DESIGN AND PROCESS ENGINEERING  
BLOUNT FINE FOODS

---

"Fill-Tech provided technical support, engineering and innovative solutions to fix our issues, as well as partnering with us to provide equipment during our continued business growth.

We were able to decrease downtime and increase yields due to their attention to detail, and excellent customer support as well as providing the latest technology in new equipment that has propelled us to another level.

One thing I liked was Fill-Tech's commitment to being a partner, working side by side with our teams, which has built a strong relationship between us."





# HOW WE DO IT

## BUILDING RELATIONSHIPS

MILLIONS OF FOOD PRODUCTS PACKED DAILY RANGING FROM POTATO SALADS, SPICES, DIPS AMONGST OTHERS.

---

The magic starts after holding a meeting with an existing or potential client to listen to their needs and requirements. The client lays out their packaging needs and Fill-Tech enquires about desired output, container size, shape, materials, and available space in the factory.



A high-angle, close-up view of a pharmaceutical production line. Multiple rows of white, shallow, circular cups are arranged on a grey metal conveyor belt. Each cup is filled with a thick, orange-colored liquid, likely a suspension, and contains several small, yellow, irregularly shaped chunks, possibly representing a specific dosage or ingredient. The cups are moving from left to right. In the background, the industrial machinery of the factory is visible, including various pipes, valves, and mechanical components. The lighting is bright and even, highlighting the texture of the liquid and the metallic surfaces.

## **ABOUT 1,75 MILLION SOUP CUPS FILLED PER DAY**

HUNDREDS OF THOUSANDS OF UNI-DOSE  
PHARMACEUTICAL CUPS FILLED PER DAY.



A photograph of three business professionals in an office setting. A man in a light blue shirt and blue striped tie is seated at a desk, looking at a laptop screen. A woman with blonde hair, wearing a dark blazer over a pink shirt, is leaning over his shoulder from the left, also looking at the screen. Another man, wearing a white shirt, is standing to the right, leaning over the seated man and smiling. The background shows a modern office with large windows and ceiling lights.

**WE  
STAND BEHIND  
EVERYTHING WE DO**



# WE LISTEN TO THE NEEDS OF OUR CUSTOMERS

---

After mutually determining the ultimate goal with the client, a team of Fill-Tech's engineers conducts a design review to outline a machine that fulfills their requirements.



A photograph of two men in a factory or industrial setting. Both are wearing yellow hard hats and light blue button-down shirts. The man on the left is older, with grey hair and a beard, wearing glasses. The man on the right is younger, also with a beard and glasses. They are both looking down at a large sheet of paper, likely blueprints, which they are holding together. The background is slightly blurred, showing industrial equipment and lighting. The overall tone is professional and focused.

**WE ARE A TEAM OF DESIGNERS AND  
MACHINERY BUILDERS WHO STUDY  
EVERY APPLICATION IN DEPTH  
PRIOR TO IMPLEMENTATION**



# CONSTRUCTION

HUNDREDS OF THOUSANDS OF HOUSEHOLD  
CONSUMER AND INDUSTRIAL PRODUCTS PACKED PER DAY.

---

Once an order has been placed and the details and design reviews have been finalized, construction starts. A lead project engineer is assigned the project, a team of engineers start designing and releasing parts to manufacturing. Standard or stock components are pulled from inventory to be staged at the assembly area where the machine will be built.

The frame structures are cut, machined, assembled, welded, polished and inspected. Once the inspection process is finished, the assemblies and sub-assemblies are put on the machine and gear boxes and Servo motors are installed. Parallel to this, the main electrical control and sub panels are built and put into the machine together with the safety guarding. When this is done, the wiring and safety circuits will be finalized.

After the machine is completed from the electro/mechanical side it will go through a component's checklist and quality inspection. Once this is complete, a team of service technicians will do the final set up and testing prior to scheduling the Factory Acceptance Test (FAT). When the FAT is complete and we get a go-ahead from the customer, the machine is prepared for shipment.

---

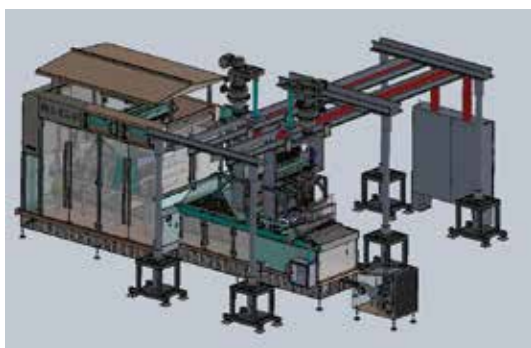



# INNOVATIVE FILLING, SEALING AND PACKAGING SOLUTIONS

---

When ready, a group of Fill-Tech's engineers are in charge of doing the machine set-up and installation. Additionally, they provide training to machine operators and maintenance personnel.

Our team strives to provide Post-installation service 24/7 to our clients as well as the delivery of spare parts if needed.

# FILL-STAR IL-81

INLINE CUP FILLING & SEALING MACHINE

The FILL-STAR IL-81 in-line cup denesting filling and sealing machine offers the best value in the industry today.

The IL-81 is controlled by a Rockwell Automation platform. The eight standard Servo axis' on the machine are controlled by using Allen Bradley kinetics 5500 controllers and A/B food grade wash down Servo motors. Custom NEMA 4X overhead electrical enclosures are used to enhance the machines wash down ability. Servo motors are used for the main drive, cup pull down, filler, fill nozzles, film drive, heat seal heads/stripper plate, cup out feed lift and the cup out-feed sweep.

Fast, efficient, easy to operate and maintain it's easy to see why the FILL-STAR series is the best solution and the best value on the market.





# ROTARY SOLUTIONS

CUP FILLING & SEALING MACHINE

---

Whether output or floorspace has brought you to the conclusion you need a rotary machine, Fill-Tech has you covered. These systems offer value, versatility, and durability.

## E-SERIES

Capable of up to 3,000 cups per hour, the E-Series satisfies entry level, lab, or other low output applications.

## R-SERIES

The R-Series is the flagship of the Fill-Tech rotary line, with speeds of up to 9,600 cups per hour and advanced features you might expect to find on large in-line machine.





# OVERCAPPERS

## OC-SERIES

MARKET-LEADING TECHNOLOGIES ARE INCORPORATED INTO ALL  
FILL-TECH EQUIPMENT

---

Fill-Tech OC series of overcapping systems provide reliable, trouble-free application of wipe on or snap-on lids. With speeds ranging from 120 up to 350 containers per minute, the OC series offers a solution for nearly any application.

Container control and lid delivery are the top two factors in any overcapping operation. The OC series delivers best-in-market performance in both areas through innovative engineering.

Whether your application calls for captivator blocks, timing screws, stabilizer belts or a combination of these, the OC series overcappers handle your product with care and speed.

These same market-leading technologies can be incorporated into Fill-Tech's filling and closing systems or a number of other existing packaging applications.

# FILL-STAR IL-81P

PHARMACEUTICAL MACHINE

---

In 2018 Fill-Tech Solutions Inc. introduced its new IL-81P pod machine for brewed drinkable pharmaceutical products.

The machine incorporated 11 Servo axis, ultra clean filling environment, 16 Servo driven augers for product filling, integrated cup tare and weigh cell systems with feed-back to augers, Servo driven lid pick and place, Servo driven heat sealing station.

Leak detection, bar code reading and lid color detection, Servo driven cup pack off and inversion, CO2 laser coding, camera system for reading OCR and an output of 300 units per minute.

---

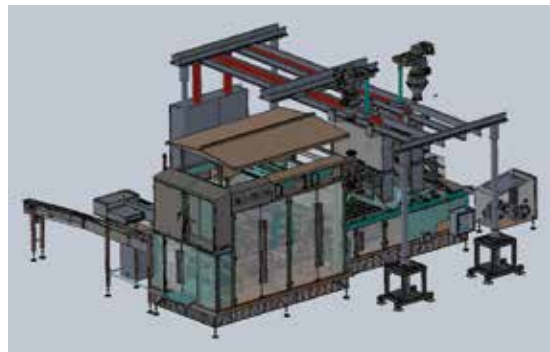
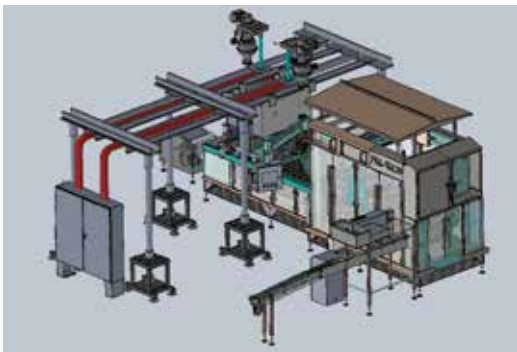





# **DRIVEN BY PASSION, DELIVERING RELATIONSHIPS**

---

**NEED TO DISCUSS YOUR NEXT PROJECT?  
CONTACT US, WE'LL BE HAPPY TO FIND A SUITABLE  
SOLUTION FOR YOUR COMPANY!**

**A. 11401 Belcher Road South Suite 230 - Largo, FL - 33773  
T. +1-727-572-8550 // F. +1-727-572-8551  
E. [sales@fill-tech.com](mailto:sales@fill-tech.com) // [www.fill-tech.com](http://www.fill-tech.com)**

---



A. 11401 Belcher Road South Suite 230 - Largo, FL - 33773  
T. +1-727-572-8550 // F. +1-727-572-8551  
E. [sales@fill-tech.com](mailto:sales@fill-tech.com) // [www.fill-tech.com](http://www.fill-tech.com)